

Assembly instructions

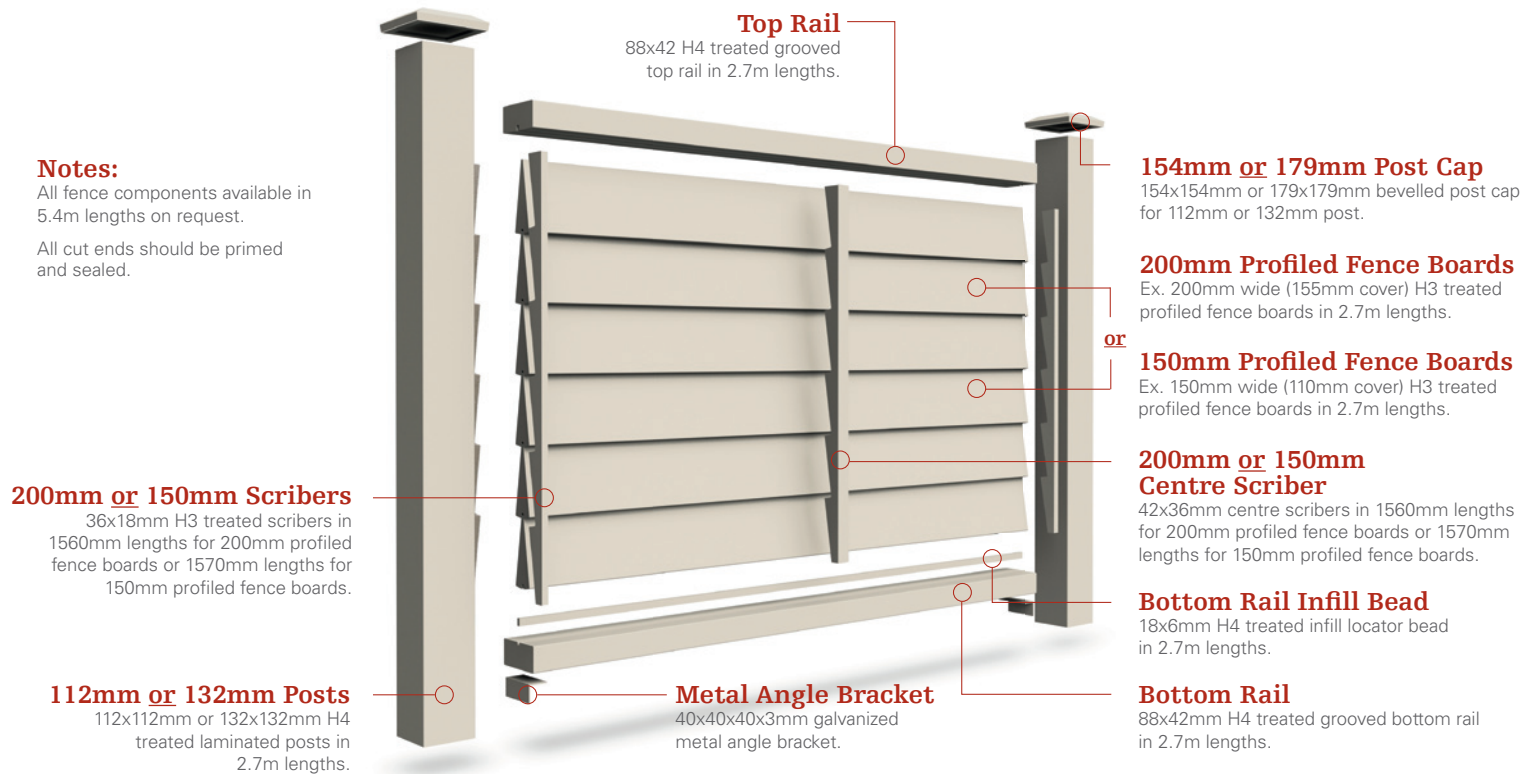

Components (overview)



All components are manufactured from clear exterior treated finger-jointed radiata pine and are machine primed and undercoated with a two-coat oil based coating system.

After assembly finish the paint system with a minimum of two premium exterior acrylic top coats with LRV 45+. Alternatively paint each component form separately before the fence is erected. This eliminates cutting in if two or more finished colours are used. (See jenkin.co.nz for further detail on painting)

What you will need

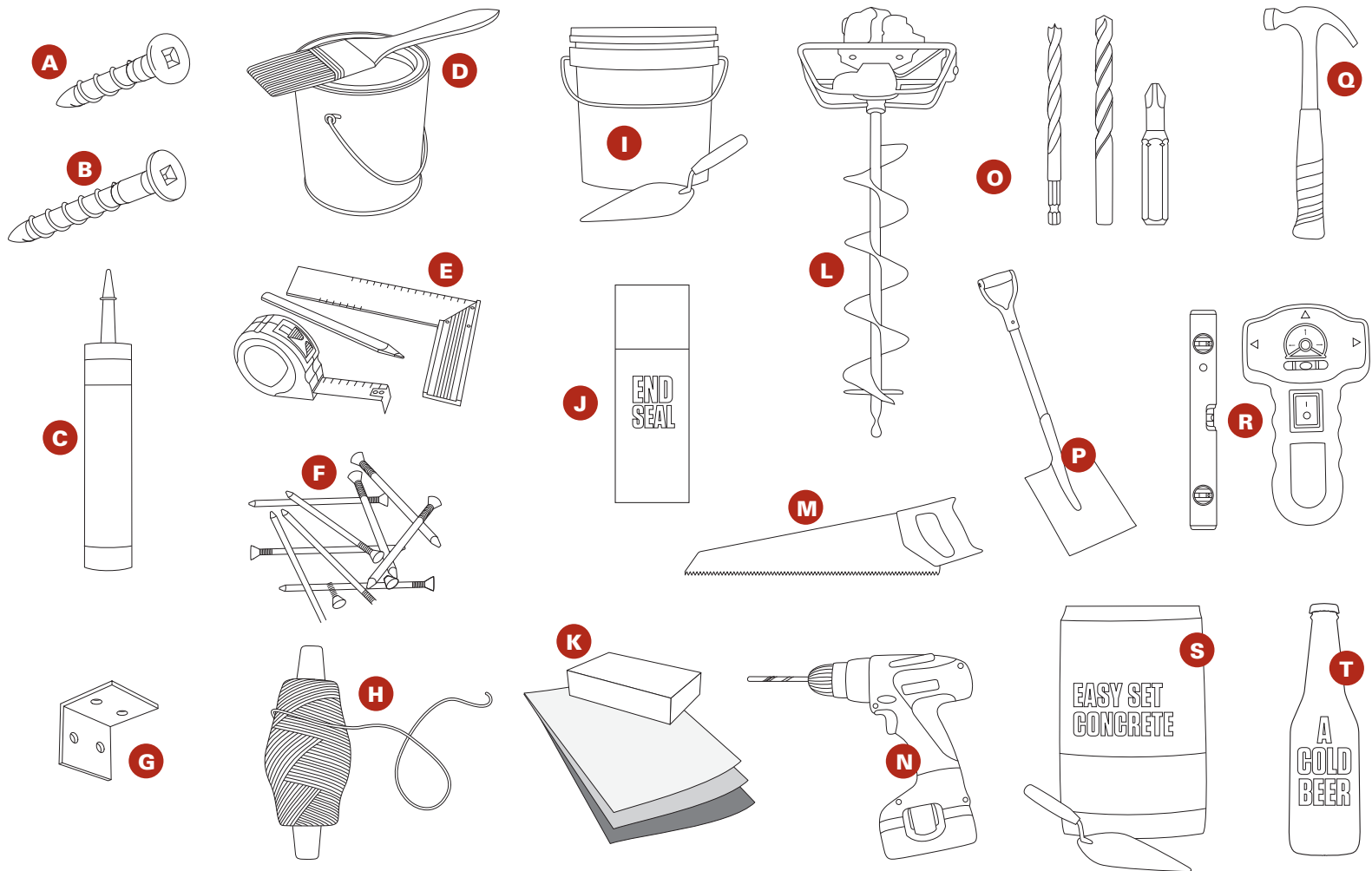

Along with the components shown in the diagram above you will need the following:

Other components:

- A. 10 gauge 40mm stainless raised head screws (allow 50 per fence segment).
- B. 8 gauge 15mm counter sink screws (allow 10 per fence segment).
- C. Timber adhesive.
- D. Premium exterior acrylic paint and brush.
- E. Square, measuring tape and pencil
- F. 20mm panel pins
- G. Metal angle brackets (two per fence segment)
- H. Stringline
- I. Woodfiller and trowel
- J. Jenkin end seal primer (used for all cut ends)

- K. Sandpaper and block

Tools:

- L. Post hole borer (300mm diameter) Optional
- M. Handsaw or circular saw
- N. Drill
- O. Drill bits (3&4mm diameter) and screwdriver bit
- P. Digging equipment
- Q. Hammer or Nail gun
- R. Spirit level or laser level
- S. Easy set concrete
- T. A cold beer to appreciate your new fence

Planning sketch and dimensions

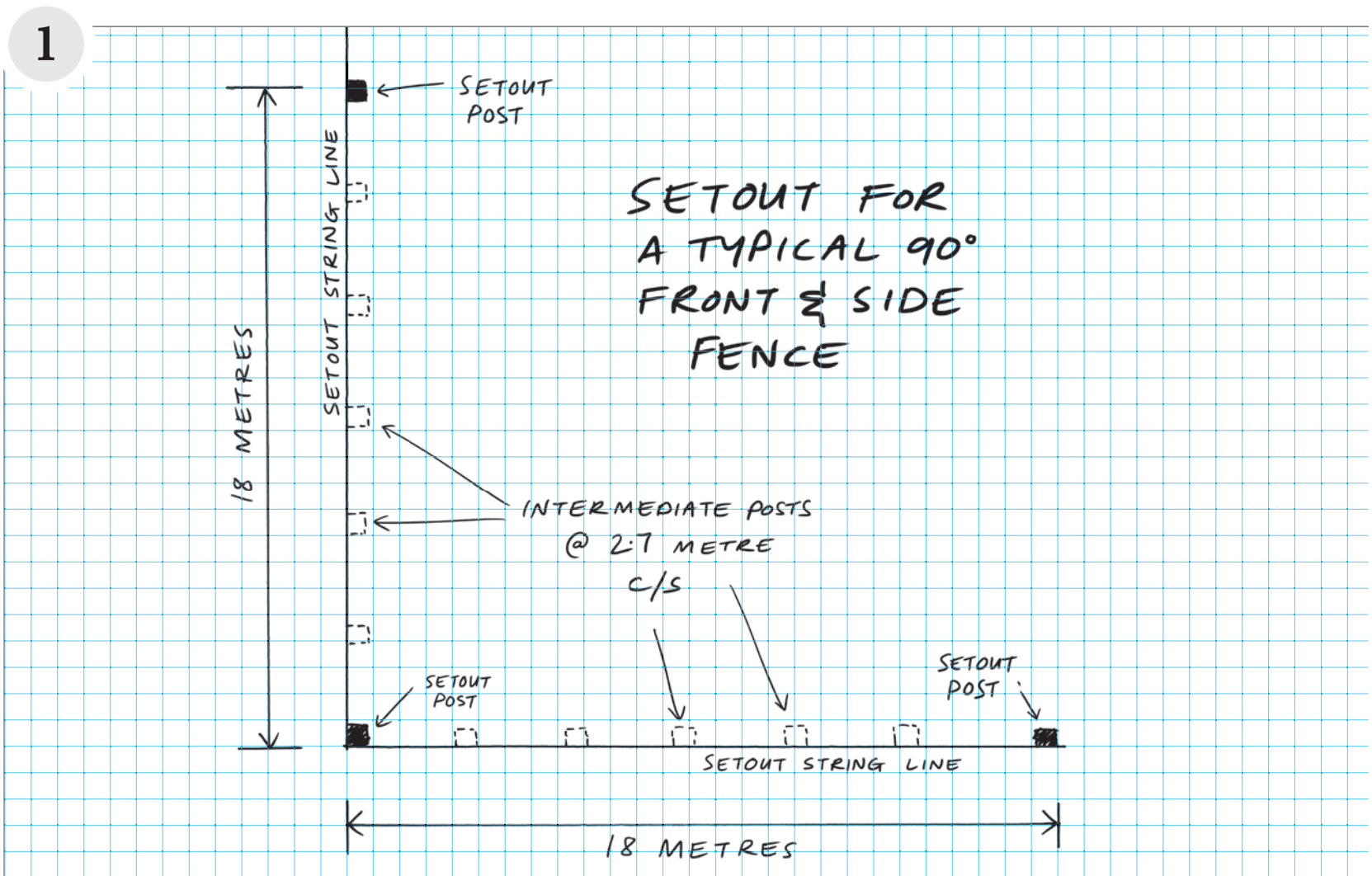

Plan: the fencing project on graph paper before proceeding. Check that the fence lines are correctly positioned in relation to the boundary and/or survey pegs. Ensure the fence and fence height conform to local council bylaws and subdivision covenants

Before digging post holes: Locate underground services such as power, gas, telephone, water and drainage to ensure a safe separation distance from excavated holes.

Installing the Posts

2

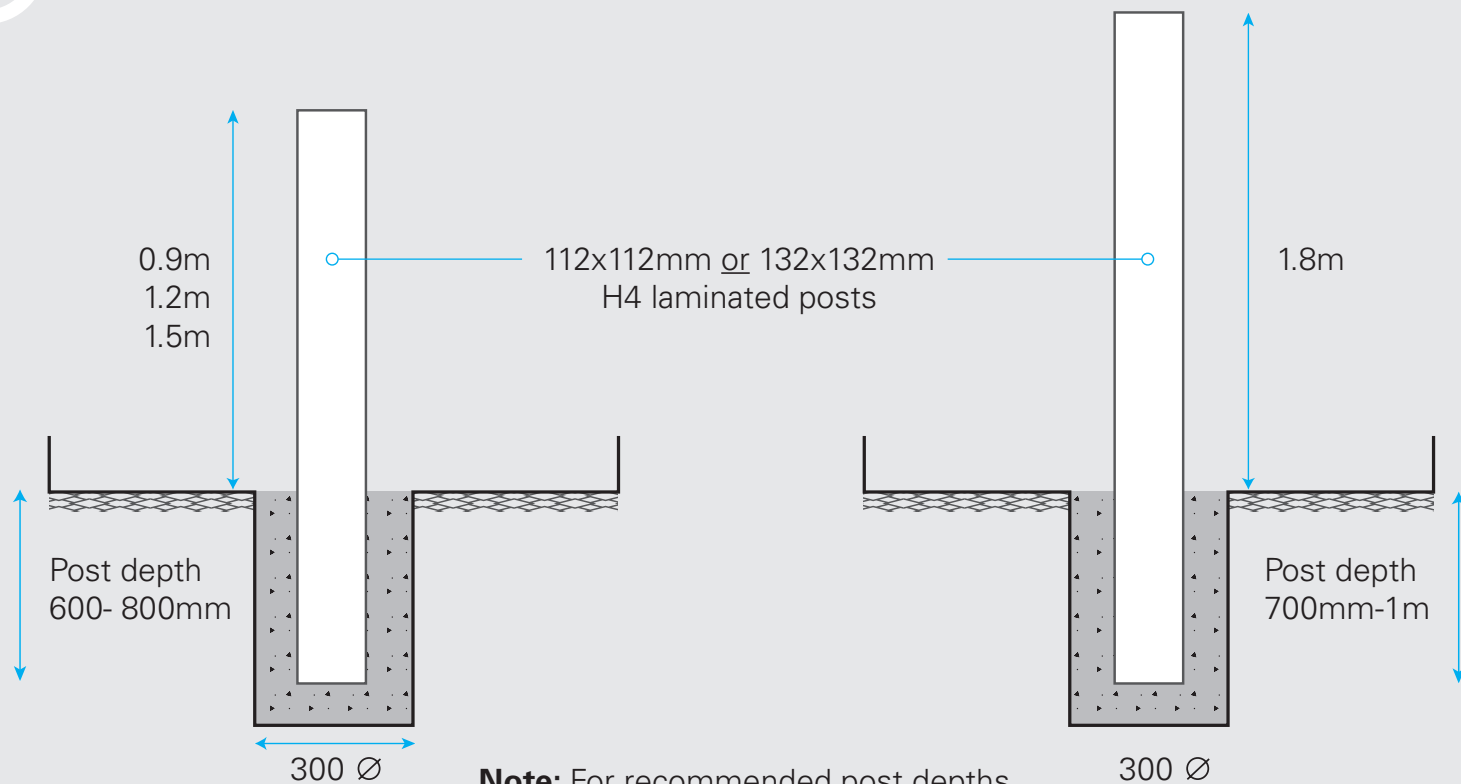

Note: For recommended post depths, relating to area wind speeds, refer to 'foundation detail' table below.

Setout: Peg out, excavate and concrete-in a post at either end of the fence line. Ensure posts are accurately positioned and plumb as these determine the accuracy of the fence line.

Intermediate Posts: Measure and install intermediate posts up to the maximum centre span of 2.7m. Horizontal and vertical alignment can be achieved by a laser or string line and level or plumb bob. Posts should be plumb and secure before proceeding.

Post size mm	Maximum Post Centres	Windzone	For Fence heights		
			0.9-1.2m	1.5m	1.8m
			Embedded depth for fence posts		
112x112	2.7m	High	600mm	700mm	-----
		Extra high	700mm	800mm	-----
		Brisbane	800mm	800mm	-----
112x112	1.8m	High	-----	-----	700mm
		Extra high	-----	-----	800mm
		Brisbane	-----	-----	800mm
132x132	2.7m	High	-----	-----	800mm
		Extra high	-----	-----	900mm
		Brisbane	-----	-----	1000mm

Fitting the Bottom Rail & Bracket

3

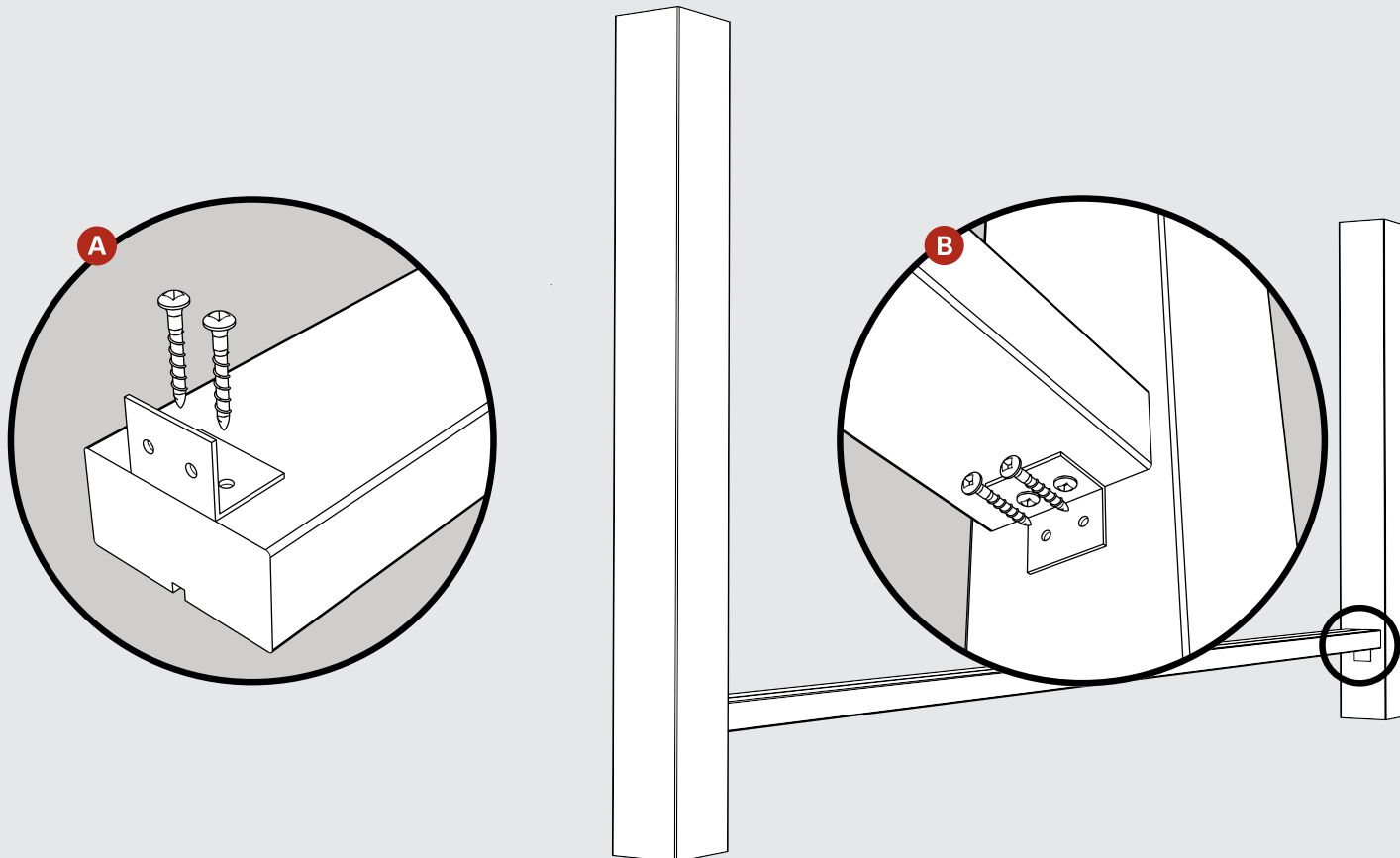

- A** Trim the 88x42mm bottom rail to the required length and fix the metal angle bracket to the underside of the rail with 10 gauge (40mm) screws.
- B** Level and fix the bottom rail on the centre line of the posts by screw-fixing through the metal angle bracket into the post. Use a spirit or laser level to ensure bottom rail is fixed level between posts.

Dealing with a sloping ground

4

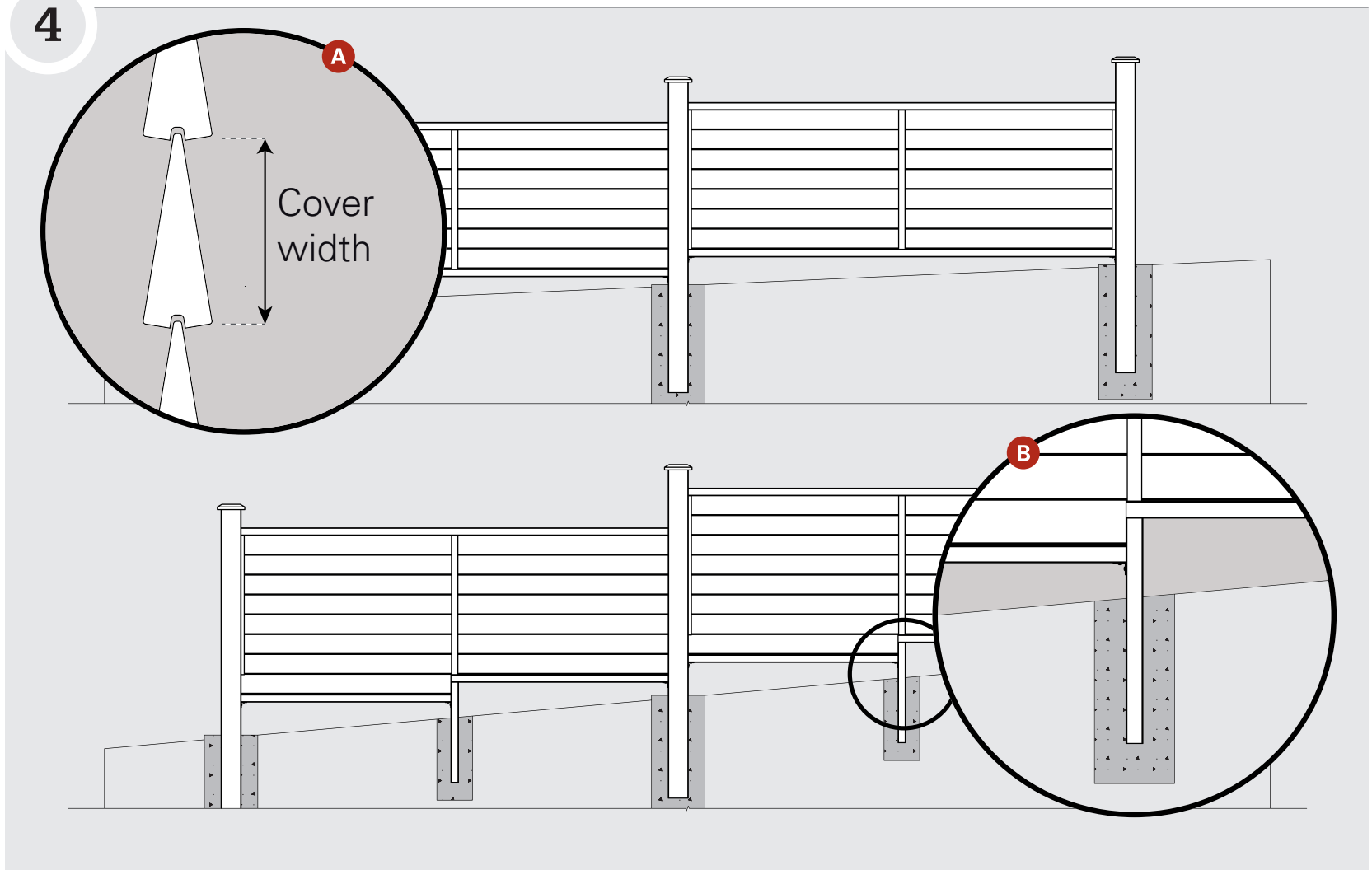

- A** Where the ground is sloping, maintain the alignment of the profiled boards by creating steps at each panel by one full board cover width — (110mm) for 150mm profiled fence board and (155mm) for 200mm profiled fence board (fence board/s).
- B** If the ground slope is severe it may be necessary to install a short stub post midway between posts to split the levels of the bottom rail.

Fitting the Bottom Rail Infill Bead

5

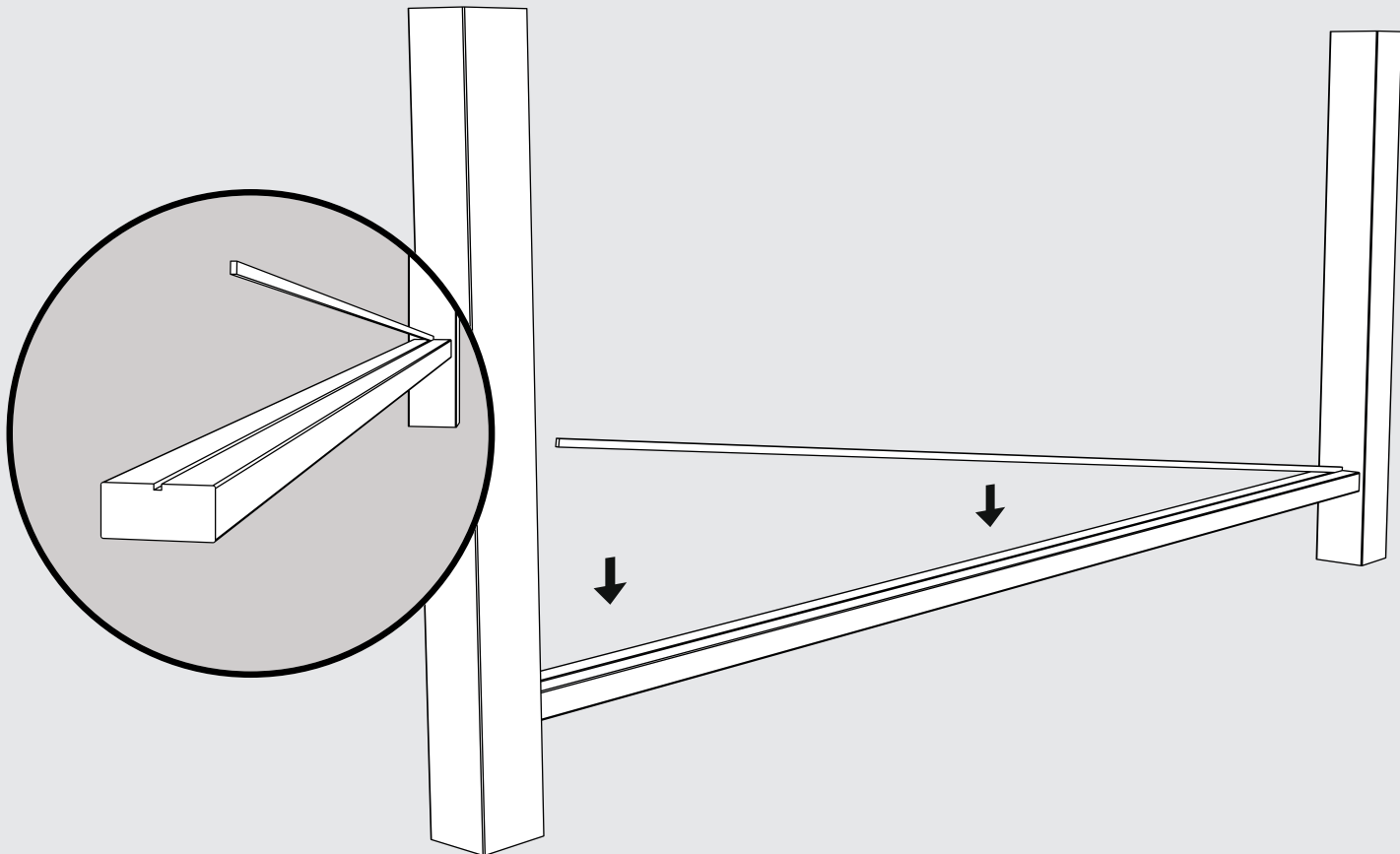

Trim the bottom rail infill bead to the length of the bottom rail. Fit the bottom rail infill bead into the centre groove of the bottom rail (tapered side up). Avoid excessive bending of the infill bead to avoid breakage.

Installing the first Profile Fence Board

6

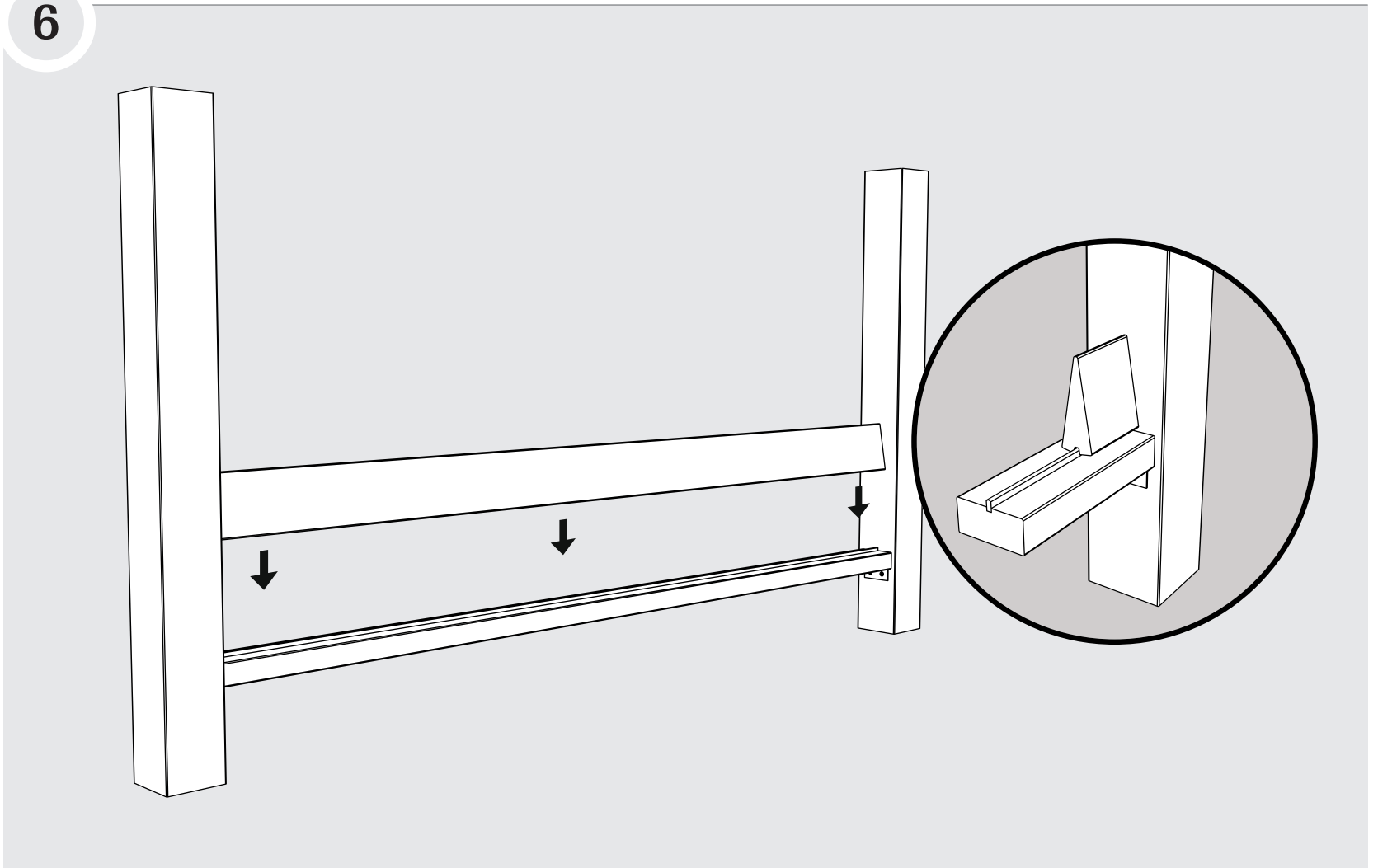

Trim the first fence board to fit. Install only the first fence board over the infill bead and bottom rail. This step assists in setting the scribes in the correct position.

Setting the front Scribers

7

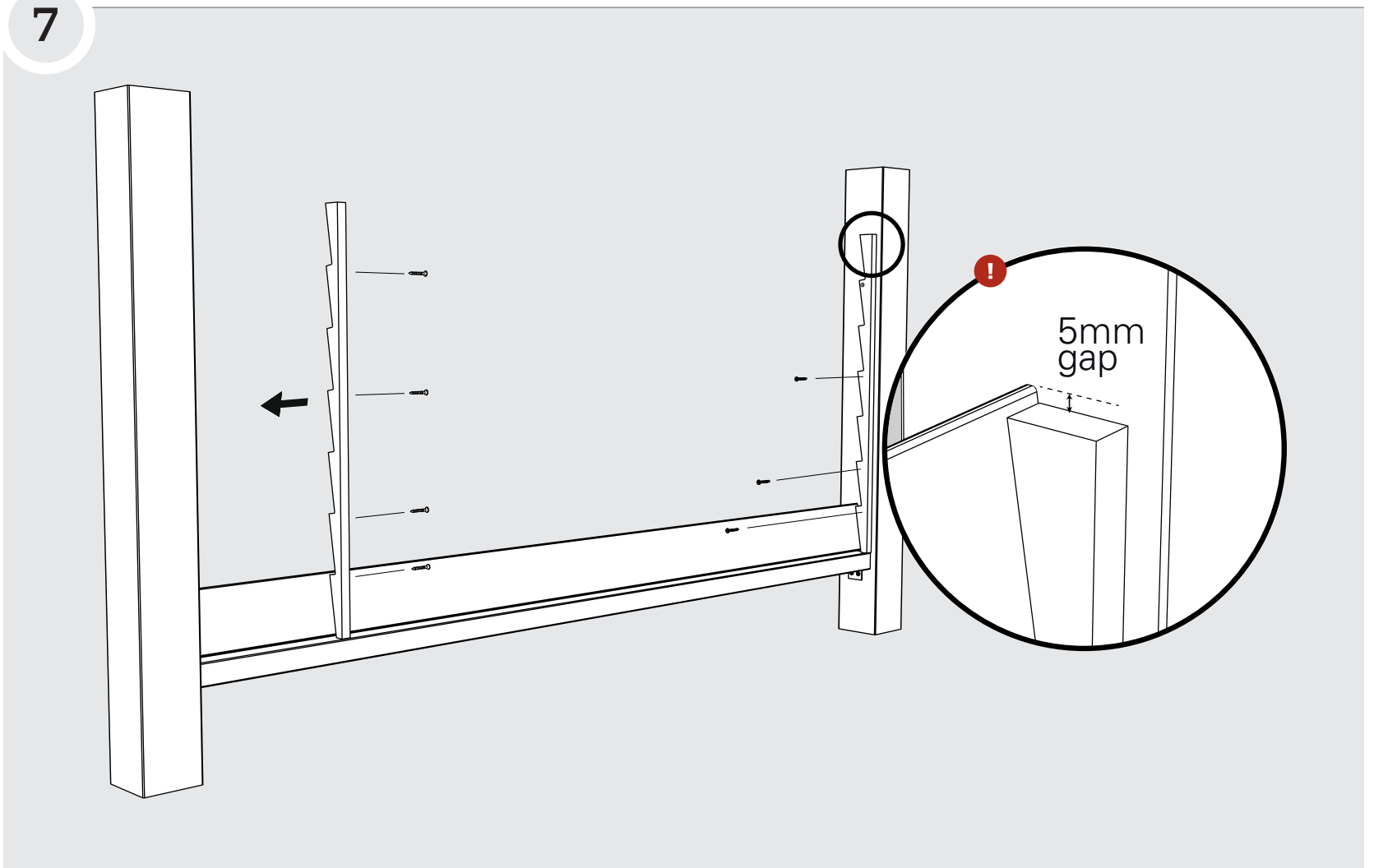

Measure, trim and locate one set of 36x18mm scribers to the front side of the fence. Fix scribe to the post with 10 gauge (40mm) stainless steel raised head screws at the top and bottom, and as required between.

- ❗ **Trim the top of the scribers 5mm below the last step to allow the top rail recess to engage and sit flat on the scribe.**

Installing three more Profiled Fence Boards

8

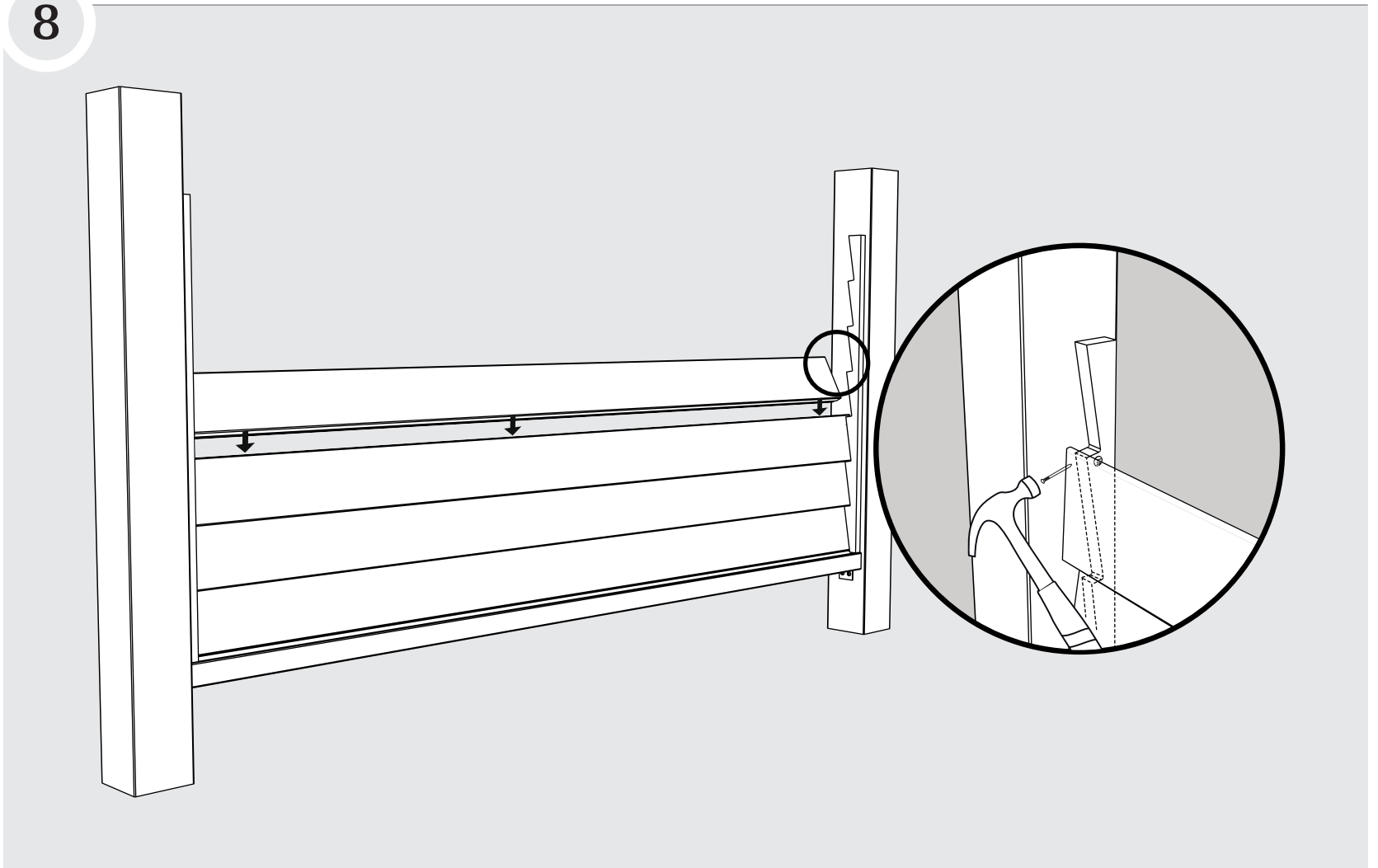

Trim and stack three more fence boards to the required height by fitting into the 36x18mm scribe. From the rear side, lightly pin through the top of the fence board to the scribe. Once set nail/punch pins flush with the profiled fence board.

Setting the front Centre Scribers

9

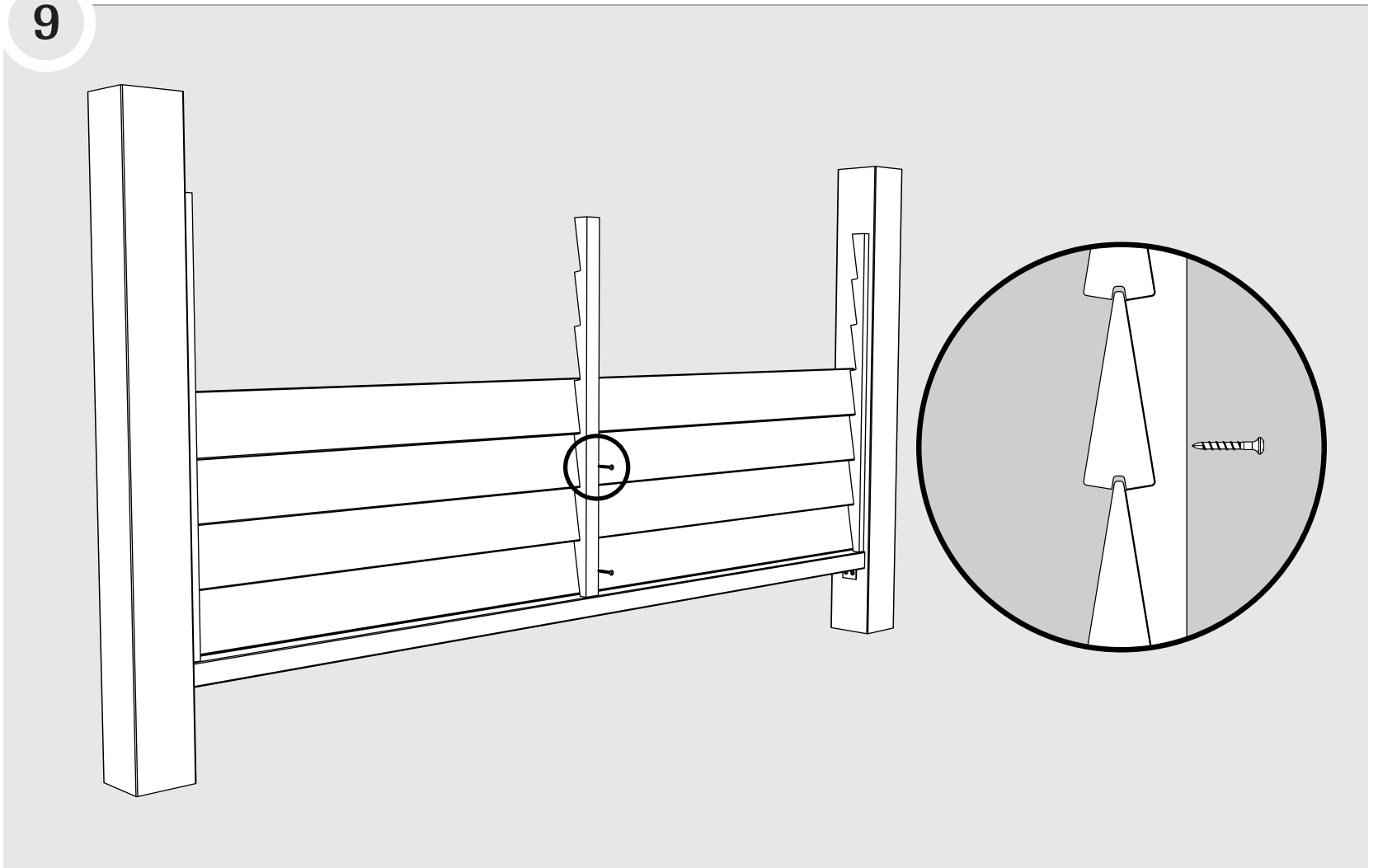

Trim the 42x36mm centre scribe to match 18mm side scribes already installed. Install centre scribe on front side after the fourth fence board is in place.

Fix centre scribe into every second rail with 10 gauge (40mm) stainless steel raised head screws. Install the remaining fence boards and lightly pin through the centre of each board.

! Do not secure the centre scribe to the bottom rail until step 11.

Setting the rear Scribers

10

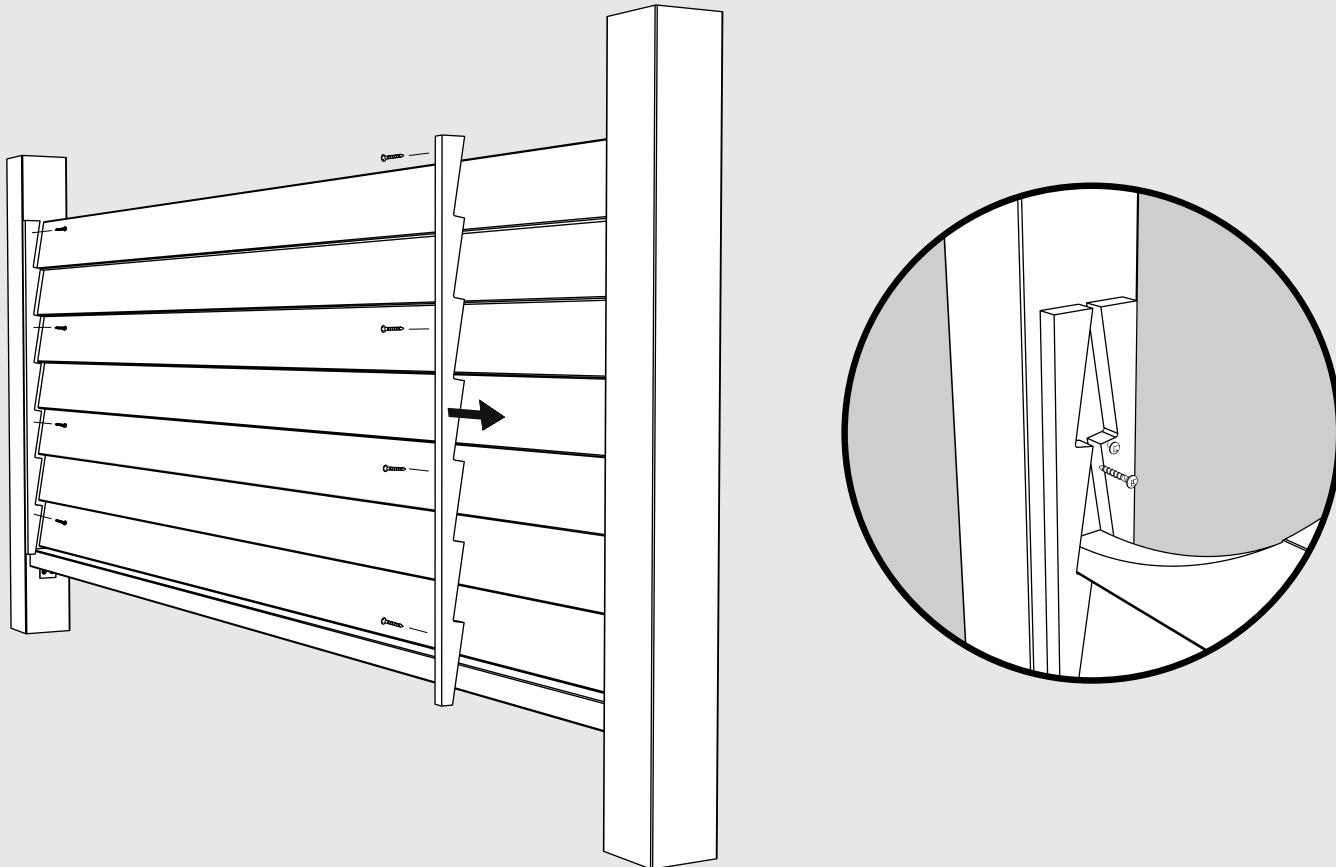

Trim and locate the rear set of 18mm side scribes to the reverse side of the fence and secure to the post as per step 7. Apply hand pressure to the scriber so it seals firmly against the fence boards.

Once all scribes are in place, holding pins (from steps 8 & 9) can either be removed or nailed off and punched.

Setting the rear Centre Scribers

11

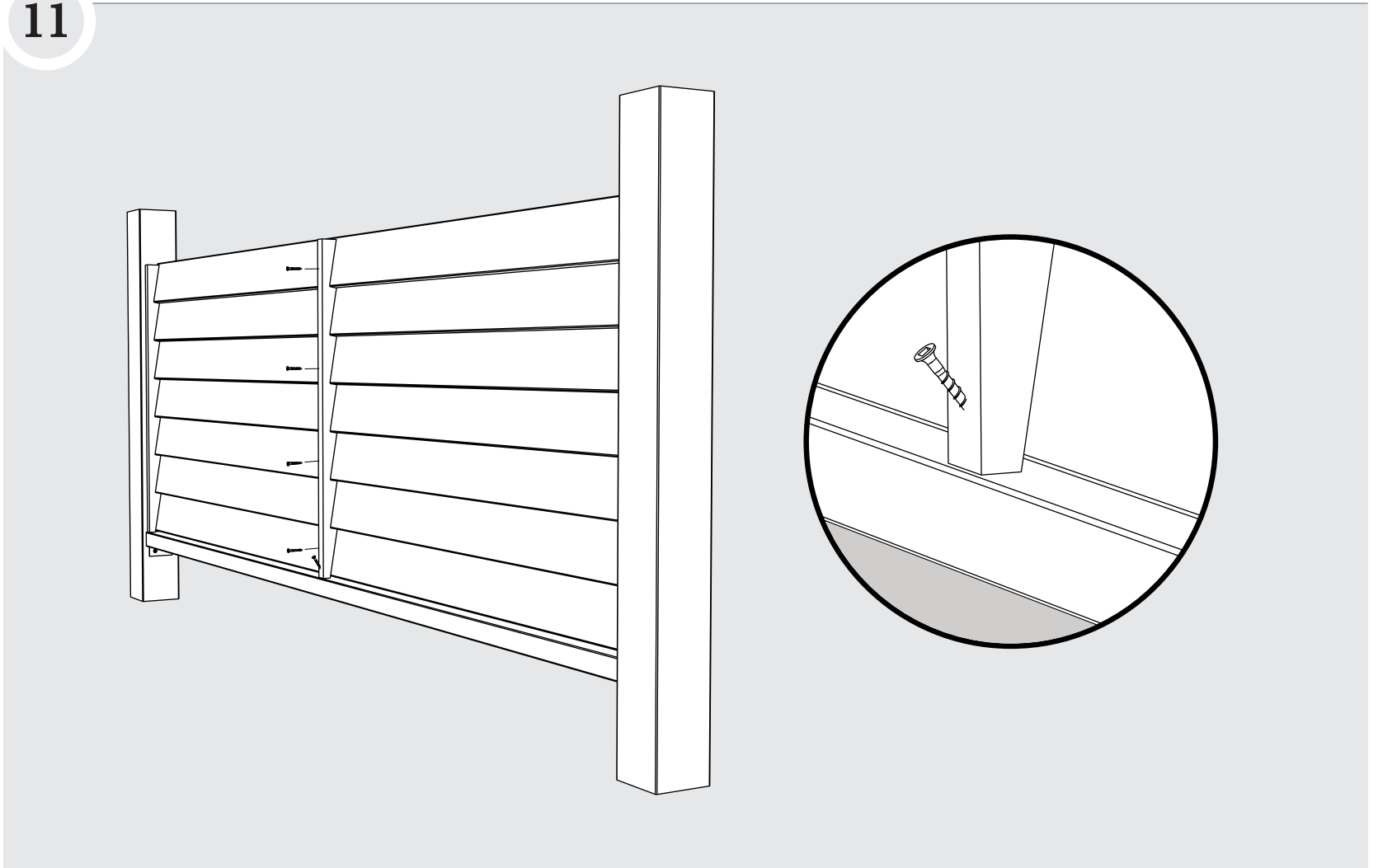

Trim and install the 42x36mm centre scribe on the rear side. Screw fix into every second fence board.

Fix centre scribe to bottom rail using 8 gauge (75mm) countersunk screws. Drill at 45° and screw fix centre scribe into the bottom rail. Seal and fill any remaining holes as required.

Installing the Top Rail and Post Caps

12

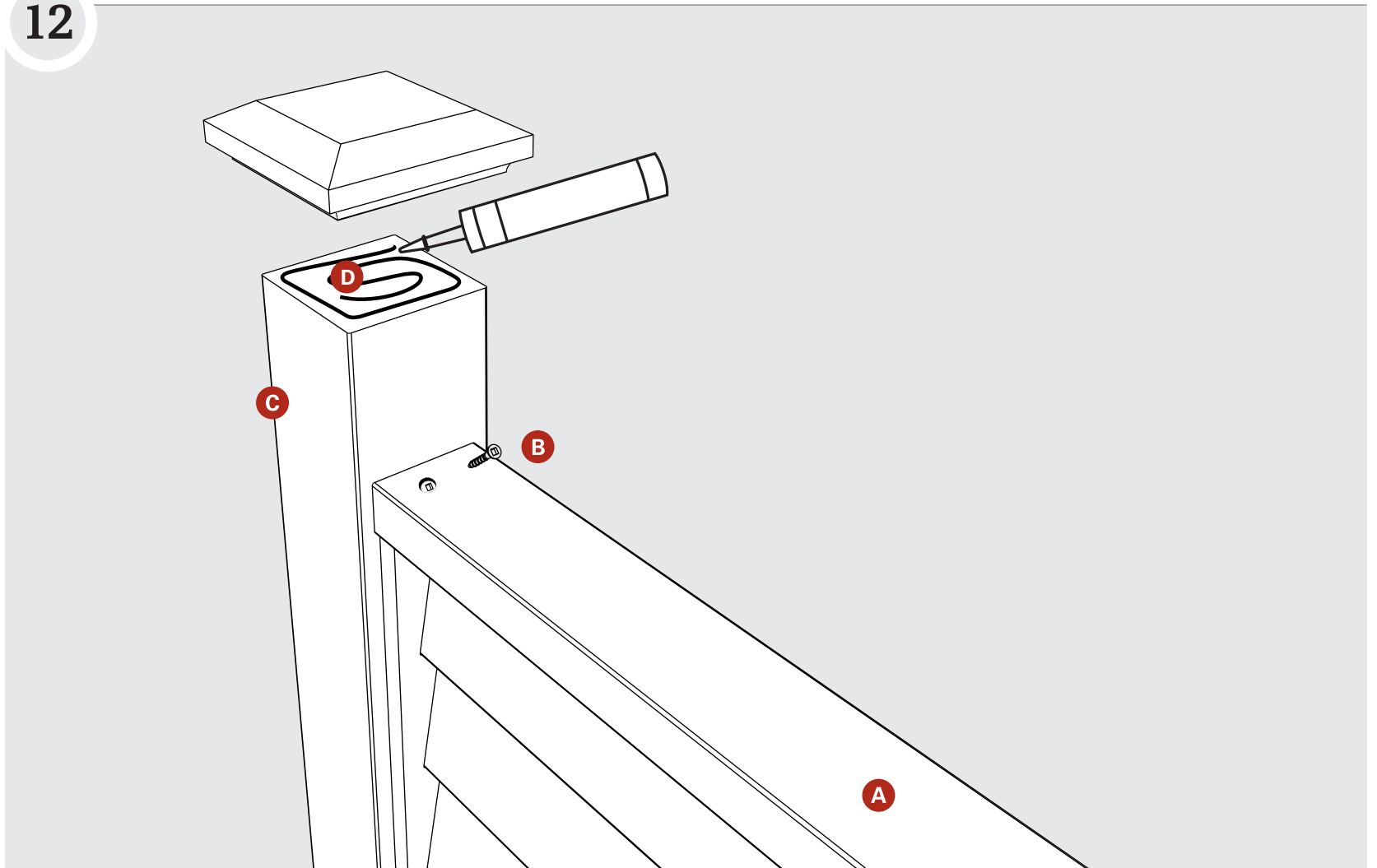

- A** Trim the top rail and engage the recess with the top fence board.
- B** Drill & countersink 45° holes for a clean finish. Screw fix the top rail at 45° into the post using a pair of 8 gauge (75mm) countersunk screws at each end. Fill hole, sand and seal for a cleaner finish.
- C** If required trim the post to the desired height.
- D** Apply adhesive to top of post, then install post cap.